

For New Labs, Renovations, or Expansion

Flexible & Modular Lab Vacuum VACUU-LAN® Networks by VACUUBRAND

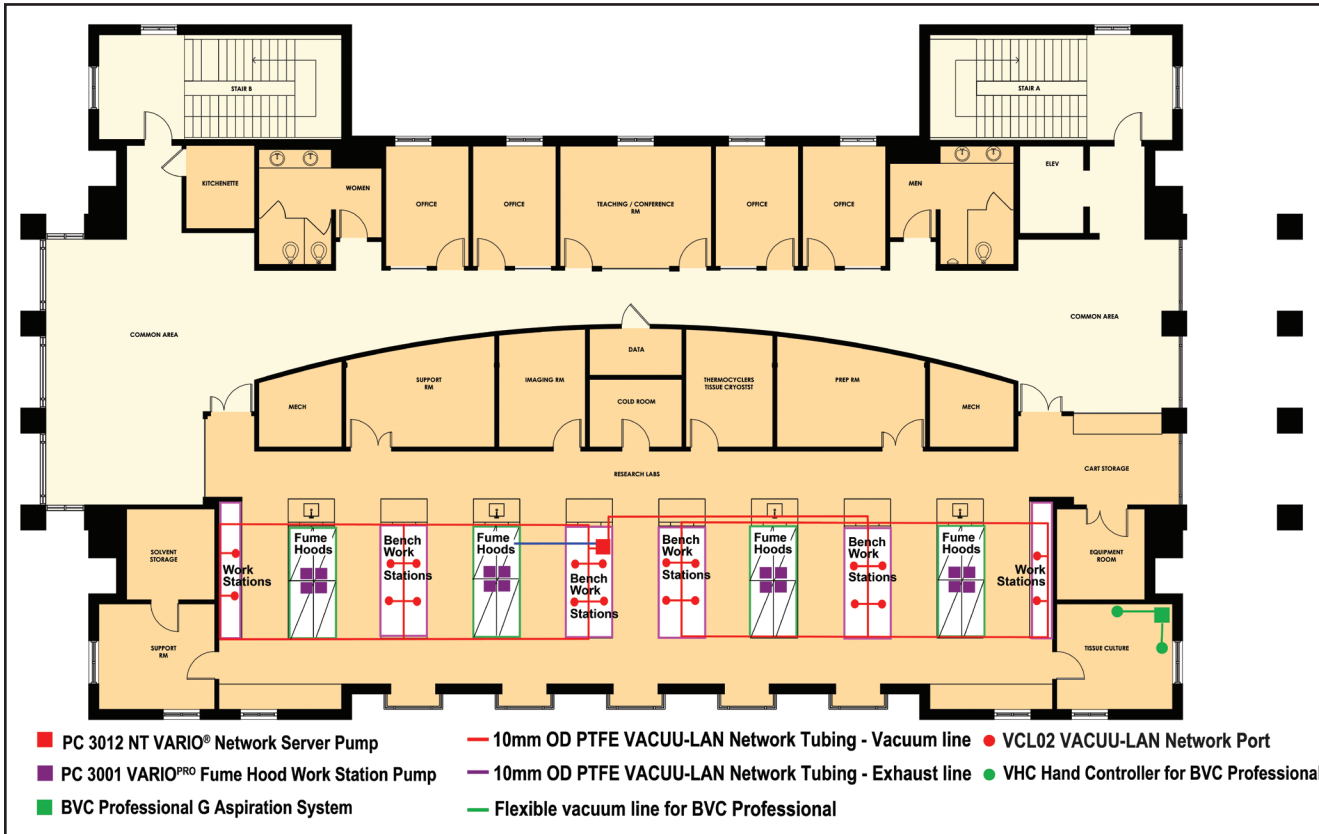

VACUU-LAN® lab vacuum networks use a single small, quiet, low maintenance pump to support between 3 and 20 lab workstations with deep, reliable vacuum.

Modular

- Vacuum only where & when you need it
- Ideal for renovations or new construction
- Eliminates building-wide central vacuum

Economical

- Fast, easy, right-sized installations
- On-demand operation reduces energy use
- Long service intervals

Adaptable

- Add/relocate later as needs change
- Upgrade networks or individual ports

“Green”

- Energy savings of up to 90%
- Replaces water-wasting aspirators
- In-lab vapor recovery reduces emissions

High-Performance

- Deep, stable bench vacuum
- Isolates critical applications
- Optional programmable vacuum control

Learn more at our micro-site:
www.vacuu-lan.com



VACUU•LAN® Network Pump Options



Pump Name	Number of Network Ports Supported* (Typ.)	Pump Dimensions (mm)	Weight (lbs)	Clearance Space Requirement (mm)	Power Requirements (V @ Hz)	Rated Motor Power (W)	Maximum Current Draw (A) (at 120 V, 60 Hz)	Typical Start-up Current Draw (A) (at 120 V, 60 Hz)	Steady Heat Load ** (BTU/hr.)	Noise (dB)	Ambient Temperature Range (°C)
For Lab Filtration, Solid Phase Extraction, and Aspiration Work - 53 torr ultimate vacuum											
ME 4C NT +2AK 52 torr, 73 lpm	Up to 6	291 H x 242 W x 316 D	30	50 mm- each side	120 V / 60 Hz	180	2.9	6	983	47	Operating Range: 10°C to 40°C Storage Range: -10°C to 60°C
ME 8C NT +2AK 52 torr, 130 lpm	Up to 12	374 H x 243 W x 319 D	37	50 mm- each side	120 V / 60 Hz	250	4	8	1365	47	Operating Range: 10°C to 40°C Storage Range: -10°C to 60°C
ME 16C NT +EK, 52 torr, 306 lpm	Up to 16	395 H x 387 W x 528 D	64	50 mm- each side	120 V / 60 Hz	440	5.5	15.5	2403	53	Operating Range: 10°C to 40°C Storage Range: -10°C to 60°C
PC 3016 NT VARIO®, 52 torr, 322 lpm	Up to 20	420 H x 387 W x 616 D	66	50 mm- each side	120 V / 60 Hz	530	8	8	721	49	Operating Range: 10°C to 40°C Storage Range: -10°C to 60°C
PC 3016 NT VARIO® DUO, 52 torr, 633 lpm	Up to 40	560 H x 925 L x 611 D	143	50 mm- each side	120 V / 60 Hz	2x 530	2x 8.0	2x 8.0	1442	55	Operating Range: 10°C to 40°C Storage Range: -10°C to 60°C
For Lab Filtration/SPE/Aspiration PLUS Evaporative Applications (Rotavaps, Concentrators, Gel Drying) with Many Common Solvents - 5 torr ultimate vacuum											
MZ 2C NT + 2AK 5 torr, 38 lpm	Up to 4	309 H x 243 W x 319 D	30	50 mm- each side	120 V / 60 Hz	180	2.9	6	983	47	Operating Range: 10°C to 40°C Storage Range: -10°C to 60°C
MZ 2C NT +AK +EK 5 torr, 38 lpm	Up to 4	402 H x 243 W x 326 D	32	50 mm- each side	120 V / 60 Hz	180	2.9	6	983	47	Operating Range: 10°C to 40°C Storage Range: -10°C to 60°C
PC 3002 VARIO® 5 torr, 47 lpm	Up to 4	444 H x 243 W x 419 D	39	50 mm- each side	120 V / 60 Hz	530	3.2	3.2	295	43	Operating Range: 10°C to 40°C Storage Range: -10°C to 60°C
For Lab Filtration/SPE/Aspiration PLUS Evaporative Applications (Rotavaps, Concentrators, Gel Drying) with High Boiling Point Solvents - 1.1-1.5 torr ultimate vacuum											
MD 4C NT + 2AK 1.1 torr, 63 lpm	Up to 8	374 H x 243 W x 319 D	37	50 mm- each side	120 V / 60 Hz	250	4	8	1365	47	Operating Range: 10°C to 40°C Storage Range: -10°C to 60°C
MD 4C NT +AK +EK 1.1 torr, 63 lpm	Up to 8	402 H x 243 W x 326 D	39	50 mm- each side	120 V / 60 Hz	250	4	8	1365	47	Operating Range: 10°C to 40°C Storage Range: -10°C to 60°C
PC 3004 VARIO® 1.1 torr, 77 lpm	Up to 8	444 H x 243 W x 419 D	46	50 mm- each side	120 V / 60 Hz	530	6.3	6.3	410	43	Operating Range: 10°C to 40°C Storage Range: -10°C to 60°C
MD 12C NT +AK +EK, 1.5 torr, 205 lpm	Up to 12	395 H x 387 W x 616 D	66	50 mm- each side	120 V / 60 Hz	440	5.5	15.5	2403	53	Operating Range: 10°C to 40°C Storage Range: -10°C to 60°C
PC 3012 NT VARIO®, 1.1 torr, 215 lpm	Up to 16	420 H x 387 W x 616 D	66	50 mm- each side	120 V / 60 Hz	530	8	8	721	49	Operating Range: 10°C to 40°C Storage Range: -10°C to 60°C
PC 3012 NT VARIO® DUO, 1.1 torr, 417 lpm	Up to 32	560 H x 925 L x 611 D	143	50 mm- each side	120 V / 60 Hz	2x 530	2x 8.0	2x 8.0	1442	55	Operating Range: 10°C to 40°C Storage Range: -10°C to 60°C

For assistance in developing an optimal VACUU•LAN® network for your lab, please call us at 1-888-882-6730 to consult with our technical team. For full product specifications, please visit www.vacuubrand.com.

* Number of Network Ports Supported is application-dependant; please contact VACUUBRAND to assist in determining the appropriate number of ports per pump for your application(s).

**For VARIO® models, indicated heat load indicates typical conditions with variable speed motor. For other models, indicated heat load is maximum steady heat load. Ensure sufficient cooling.

Vacuum Port Options

<p>Control Options - Manual or Electronic</p>  <p>VCL-02 CVC3000</p>	<p>Mounting Options - Surface, Flush, or Fume Hood</p>  <p>VCL-01 Surface mounting base VCL-RMS Flushmounting base VCL-AR Fume-hood mounting base</p>
--	---

FlexModLab_FLY_V4-13

Product appearance, catalog numbers, prices, specifications, and technical information are subject to change without notice.